

# PRODUCT SUBMITTAL

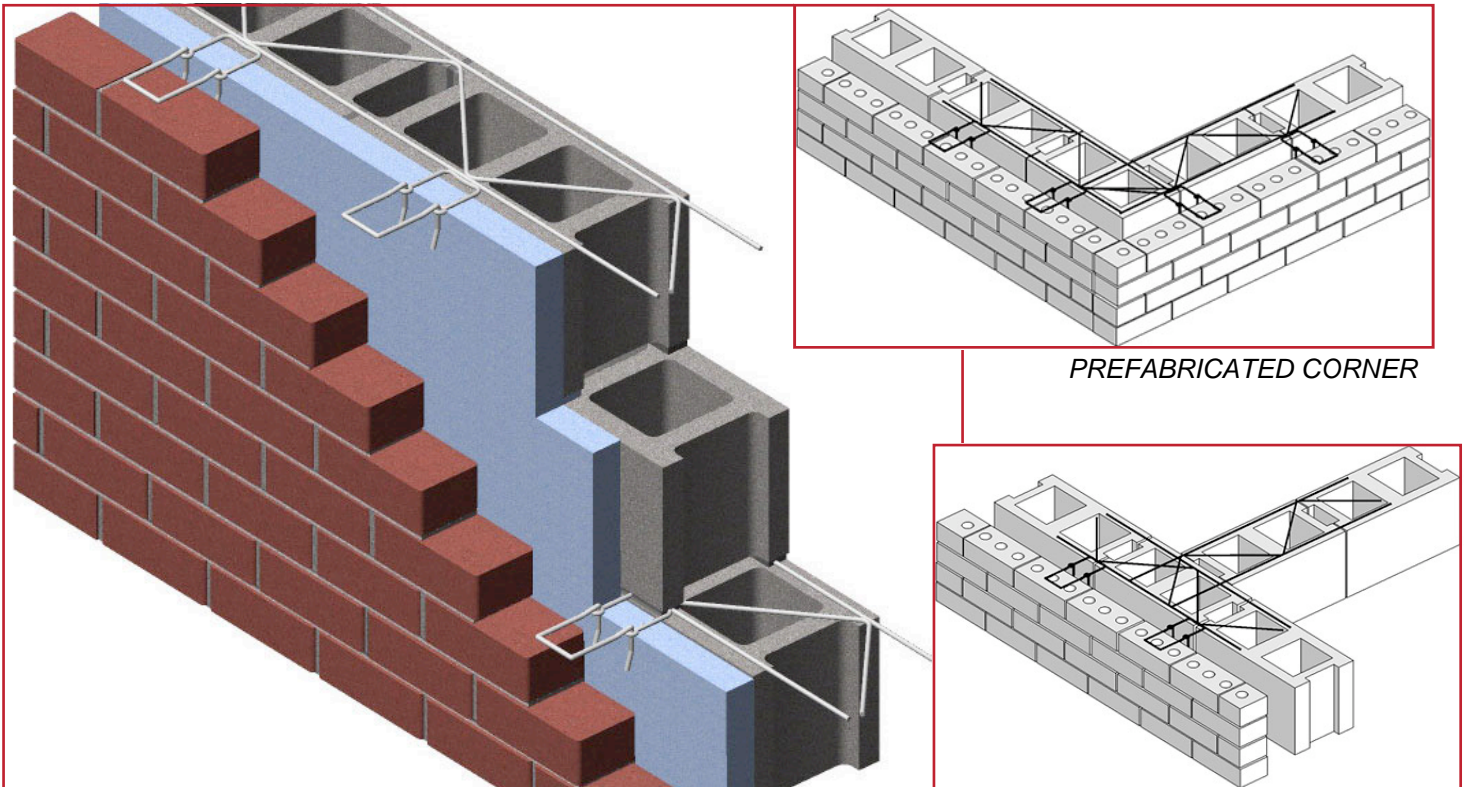

**WIRE-BOND**

## Series 900 Truss Level-Eye Ladder (Hook & Eye)



Cross rods welded 16" O.C.

- Double eye is butt welded to side rod 16" O.C.
- Height of double eye will not exceed 3/16" in bed joint.
- Easier to maintain 3/8" mortar joint.

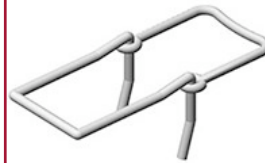

3/16" Hook & Eye

PREFABRICATED CORNER

PREFABRICATED TEE

### MATERIAL CONFORMANCE

**ASTM A82 / A82M** - (Cold drawn steel wire)  
 Tensile Strength - 80,000 psi  
 Yield Point - 70,000 psi  
**ASTM A951 / A951M-06** - (Standard Specification for Steel Wire for Masonry Joint Reinforcement)  
**ACI / ASCE 530** - (Building code requirements for masonry structures  
 Mill Galvanized / Zinc Coating: **ASTM A641 / A641M (0.10 oz per sq ft)**  
 Hot Dip Galvanized after fabrication / Zinc Coating  
**ASTM A153 / A153M-B2 (1.50 oz per sq ft)**  
 Stainless Steel **ASTM 580 / ASTM 580M Type 304** (Type 316 available on special order)

#### WIRE Recycled Content:

Mill Galvanized & Hot Dip,  
 85% Post-Consumer  
 13% Post Industrial / Pre - Consumer  
 Stainless Steel,  
 60% Post Consumer  
 V O C Content - 0%



### SIZES / FINISHES

- Mill Galvanized / Zinc Coating: **ASTM A641 / A641M (0.10 oz per sq ft)**
- Hot Dip Galvanized after fabrication / Zinc Coating  
**ASTM A153 / A 153 - B2 (1.50 oz per sq ft)**
- Stainless Steel **ASTM 580 / ASTM 580M Type 304** (Type 316 available on special order)

	Side Rods	Cross Rods
<input type="checkbox"/> Standard	9 Gauge (.148 in)	9 Gauge
<input type="checkbox"/> Heavy Duty	3/16" (.187 in)	9 Gauge
<input type="checkbox"/> Extra Heavy Duty	3/16" (.187 in)	3/16"

**Corporate Office:** 400 Roundtree Rd Charlotte, NC 28217  
 TEL: (800) 849-6722 FAX: (704) 525-3761

**Mailing Address:** P.O. Box 240988 Charlotte, NC 28224



[www.wirebond.com](http://www.wirebond.com)

**Memphis Plant:** 2365 Harbor Ave. Memphis, TN 38113  
 TEL: (800) 441-8359 FAX: (901) 775-9449

**Mailing Address:** P.O. Box 13124 Memphis, TN 38113