

# PRODUCT SUBMITTAL

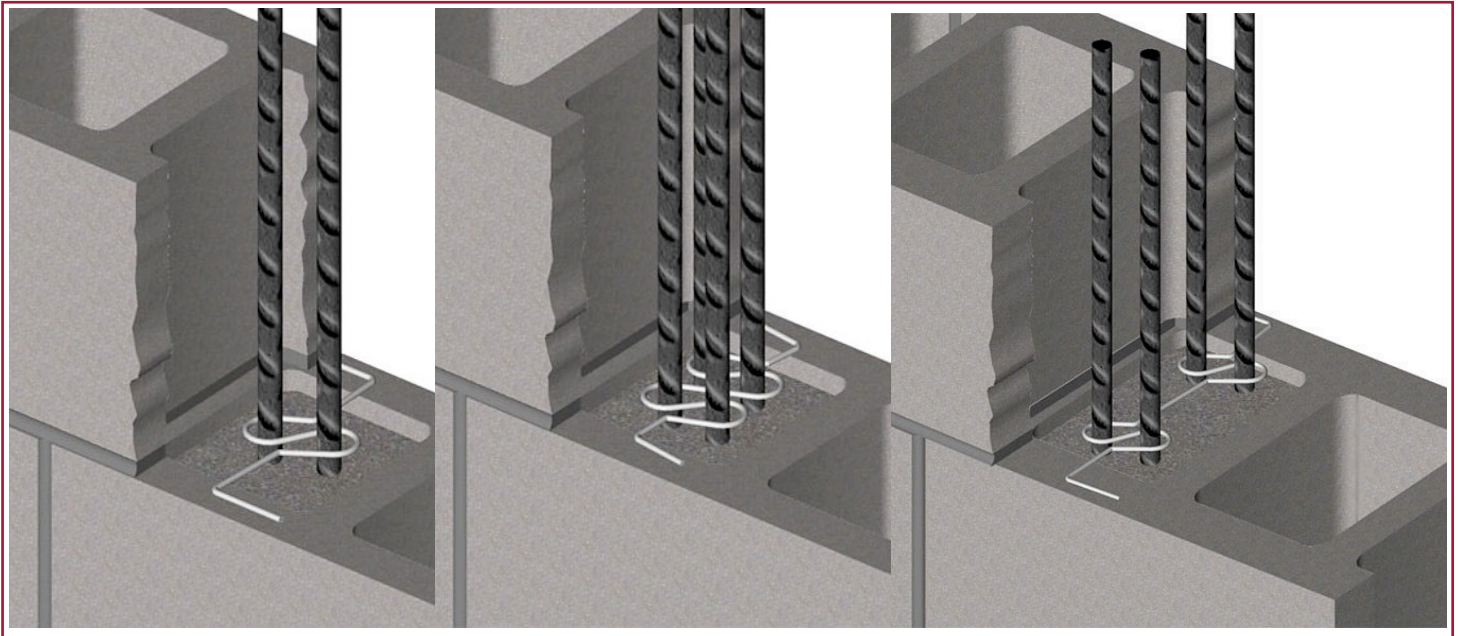

## Rebar Positioners Figure 8



# 3403  
Single for  
8" CMU

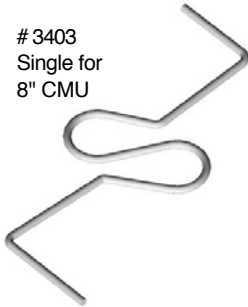

# 3404  
Double for  
8" CMU

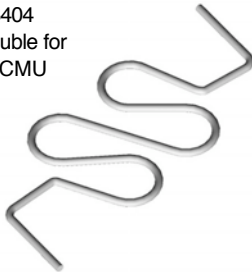

# 3404  
Double for  
12" CMU

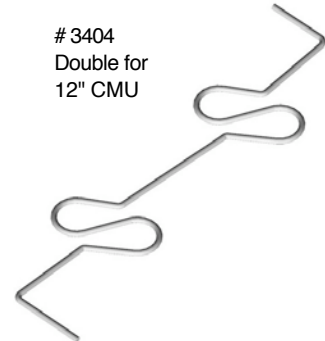

All positioners accept up to # 8 rebar

MATERIAL CONFORMANCE	DESCRIPTION / SIZES / FINISHES
<p><b>ASTM A82 / A82M</b> - (Cold drawn steel wire) Tensile Strength - 80,000 psi Yield Point - 70,000 psi <b>ASTM A951 / A951M-06</b> - (Standard Specification for Steel Wire for Masonry Joint Reinforcement) <b>ACI / ASCE 530</b> - (Building code requirements for masonry structures Mill Galvanized / Zinc Coating: <b>ASTM A641 / A641M (0.10 Oz per sq ft)</b> Hot Dip Galvanized after fabrication / Zinc Coating <b>ASTM A153 / A153M-B2 (1.50 oz per sq ft)</b> Stainless Steel <b>ASTM 580 / ASTM 580M Type 304</b> (Type 316 available on special order)</p> <p><b>WIRE Recycled Content:</b> Mill Galvanized &amp; Hot Dip, 85% Post-Consumer 13% Post Industrial / Pre - Consumer Stainless Steel, 60% Post Consumer V O C Content - 0%</p> 	<p><b>DESCRIPTION:</b> Controls location of rebar, avoiding the edges of the cores of the blocks. Accepts up to # 8 rebar</p> <p><b>GAUGES:</b> <input type="checkbox"/> 9 GAUGE    <input type="checkbox"/> 3/16"Ø</p> <p><b>SIZES FOR CMU:</b> <input type="checkbox"/> 6" Single    <input type="checkbox"/> 8" Single    <input type="checkbox"/> 8" Double    <input type="checkbox"/> 12" Single    <input type="checkbox"/> 12" Double</p> <p><b>FINISH:</b> <input type="checkbox"/> Mill Galvanized    <input type="checkbox"/> Hot Dip Galvanized    <input type="checkbox"/> Stainless Steel</p>

Corporate Office: 400 Roundtree Rd Charlotte, NC 28217  
TEL: (800) 849-6722 FAX: (704) 525-3761

Mailing Address: P.O. Box 240988 Charlotte, NC 28224



www.wirebond.com

Memphis Plant: 2365 Harbor Ave. Memphis, TN 38113  
TEL: (800) 441-8359 FAX: (901) 775-9449

Mailing Address: P.O. Box 13124 Memphis, TN 38113