

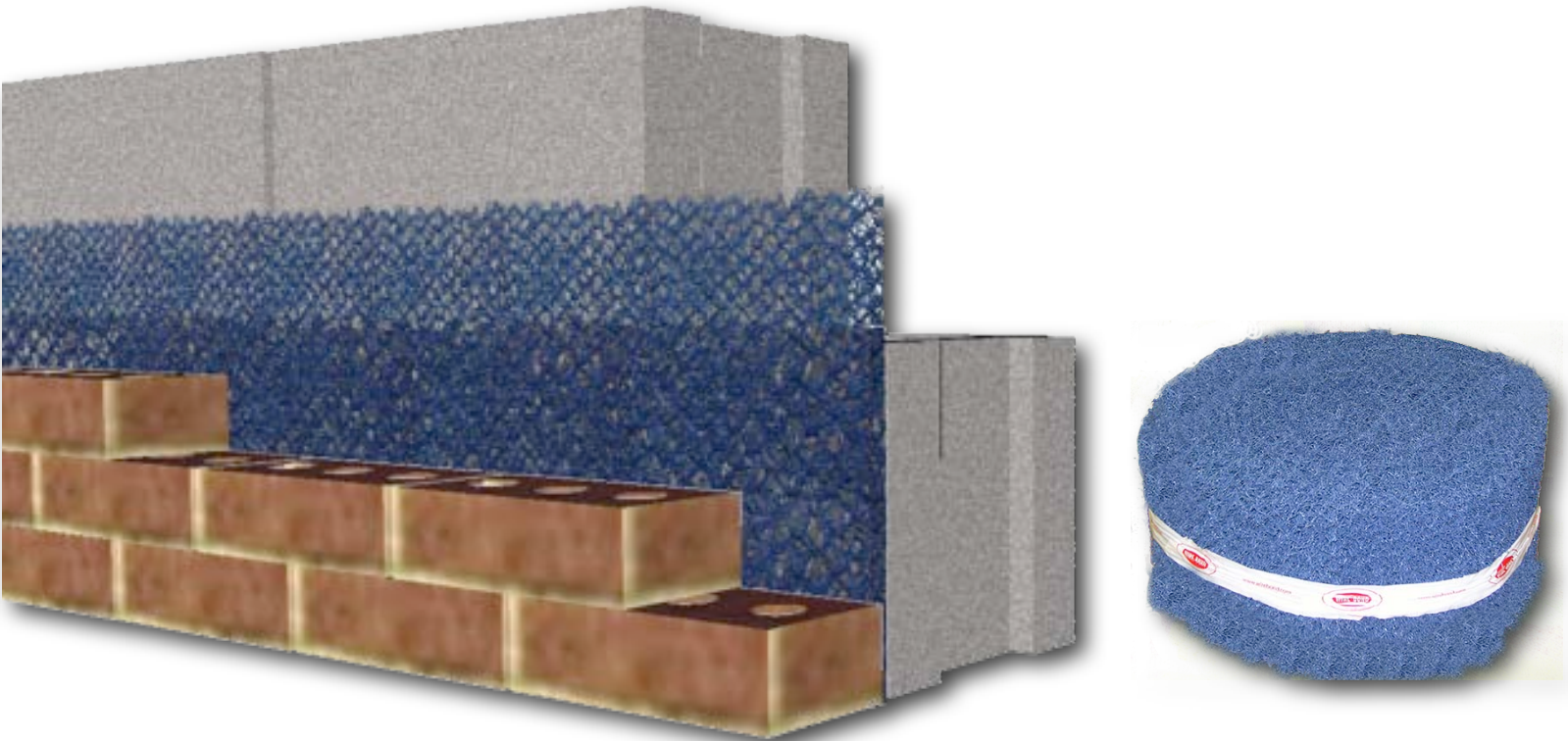

CAVITY NET I

MORTAR SUSPENSION



Cavity Net I :

- ◆ Polymer core geomatrix composed of high density polyethylene strands woven into a .80" thick mesh.
- ◆ Allows moisture to seep down through any mortar droppings and exit the cavity wall through the weep holes.
- ◆ Used in cavity walls ranging from 1" to 1-3/4" in width.

ASTM D5035



Post Consumer :
Post Industrial / Pre Consumer:

0% Recycled Content
40% Recycled Content

Cavity Net I:

- ◆ **10" in height**
- ◆ **50 ft per roll**
- ◆ **Packaged 200 ft per box**

Corporate Office
400 Rountree Road
PO Box 240988
Charlotte, NC 28224
704 525.5554
800 849.6722
Fax: 704 525.3761



www.wirebond.com

Memphis Plant
2365 Harbor Avenue
PO Box 13124
Memphis, TN 38113
901 775.9444
800 441.8358
Fax: 901 775.9449



CAVITY NET II

Mortar Suspension

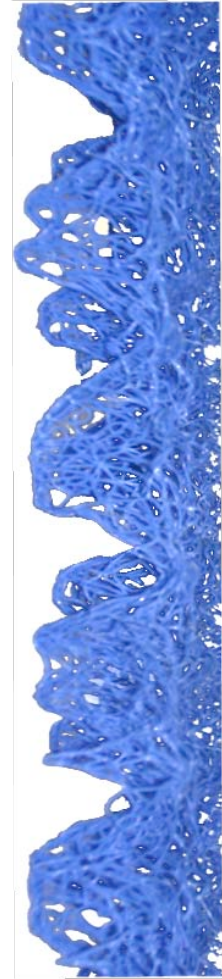
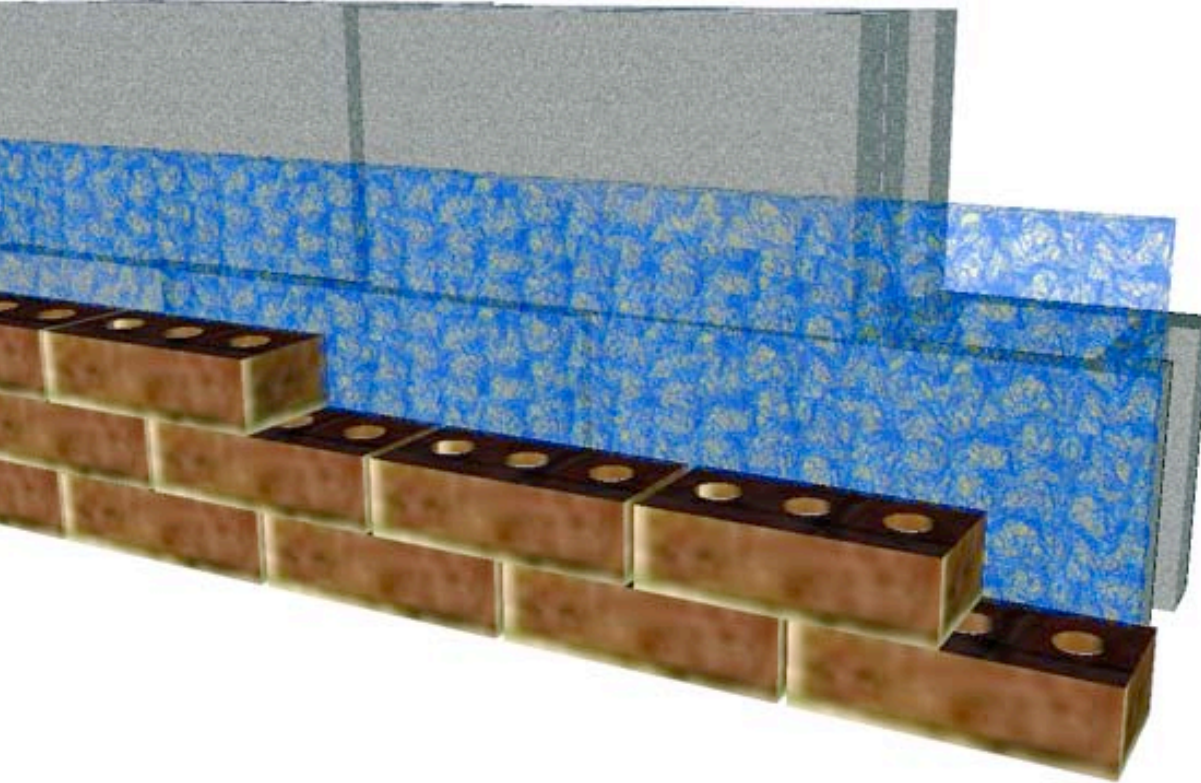

Cavity Net II :

- ◆ 1.5" Thick high density polyethylene geometric design.
- ◆ Staggered design suspends mortar droppings and redirects moisture to the exterior by way of the weep holes.
- ◆ Slightly narrower design helps avoid any possible bridging of mortar across the cavity.
- ◆ Used for cavities 2" and wider.

ASTM D5035

**Post Consumer :
Post Industrial / Pre Consumer:**

**0% Recycled Content
40% Recycled Content**



Cavity Net II :

- ◆ **10" in height**
- ◆ **35 ft per roll**
- ◆ **Packaged 140 ft per box**

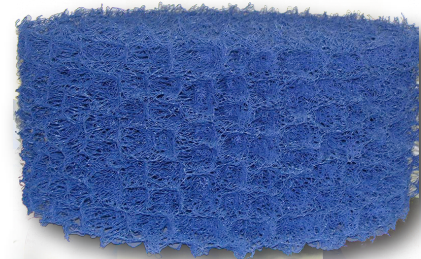

Corporate Office
400 Rountree Road
PO Box 240988
Charlotte, NC 28224
704 525.5554
800 849.6722
Fax: 704 525.3761



www.wirebond.com

Memphis Plant
2365 Harbor Avenue
PO Box 13124
Memphis, TN 38113
901 775.9444
800 441.8358
Fax: 901 775.9449